

Pflegehinweis!

Bitte nur mit einem Staubtuch
 oder einem feuchten Lappen reinigen.
KEINE scheuernde
 Putzmittel verwenden !

**Wskazówka dotycząca
 pielęgnacji!**

Proszę czyścić tylko suchą
 lub lekko wilgotną szmatką do kurzu.
 Nie używać żadnych środków szorstkich !

MONTAGEANLEITUNG
INSTRUKCJA MONTAŻOWA

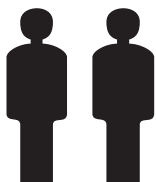

2 Personen
2 Osoby

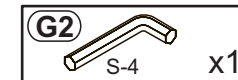
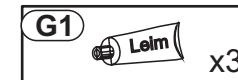
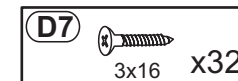
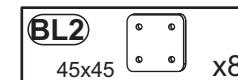
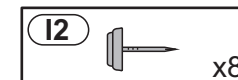
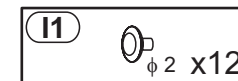
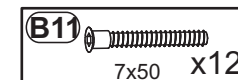
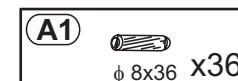
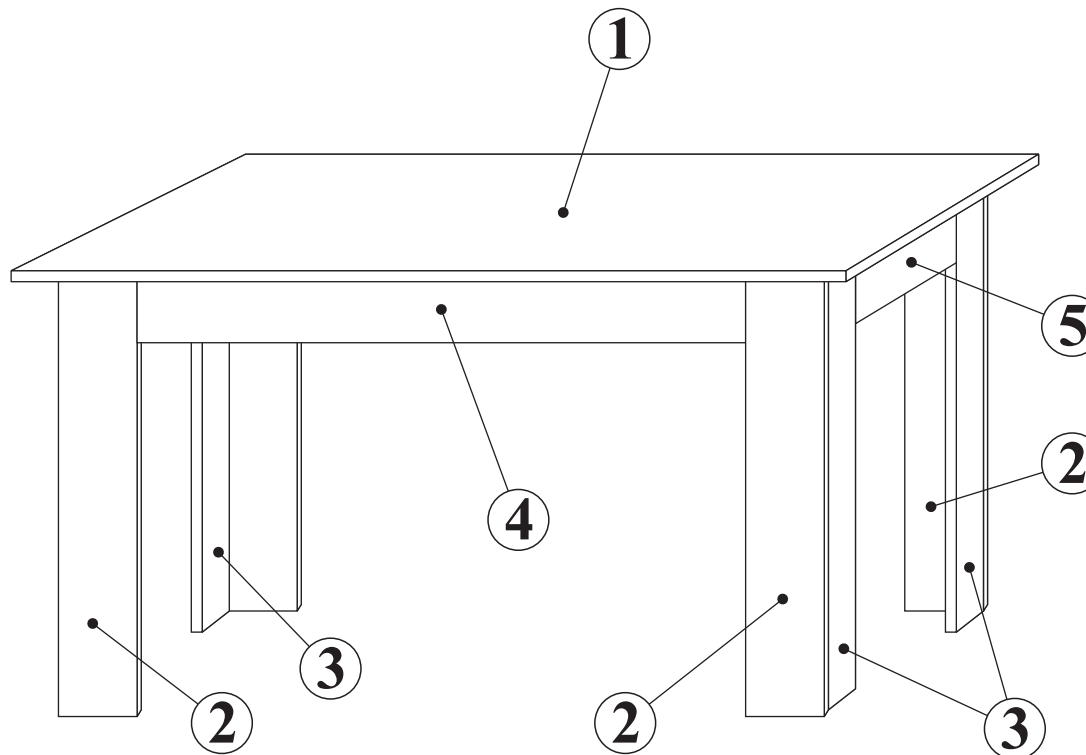
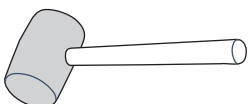
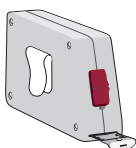
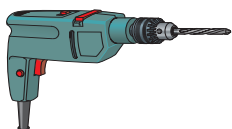

Max. zulässige Belastungen
 von Einlegeböden in kg:
 Maksymalne obciążenie półek w kg:

| Stärke/Gr. Länge/Dł. mm | Spanplatte/Płyta | | |
|----------------------------|------------------|----|----|
| | 15 | 18 | 22 |
| 0<400 | | | |
| 401<600 | 40 | 40 | 40 |
| 601<800 | 24 | | |
| 801<1000 | 15 | 30 | |

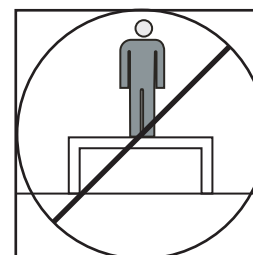
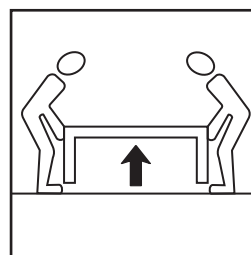
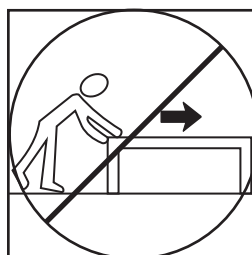

1

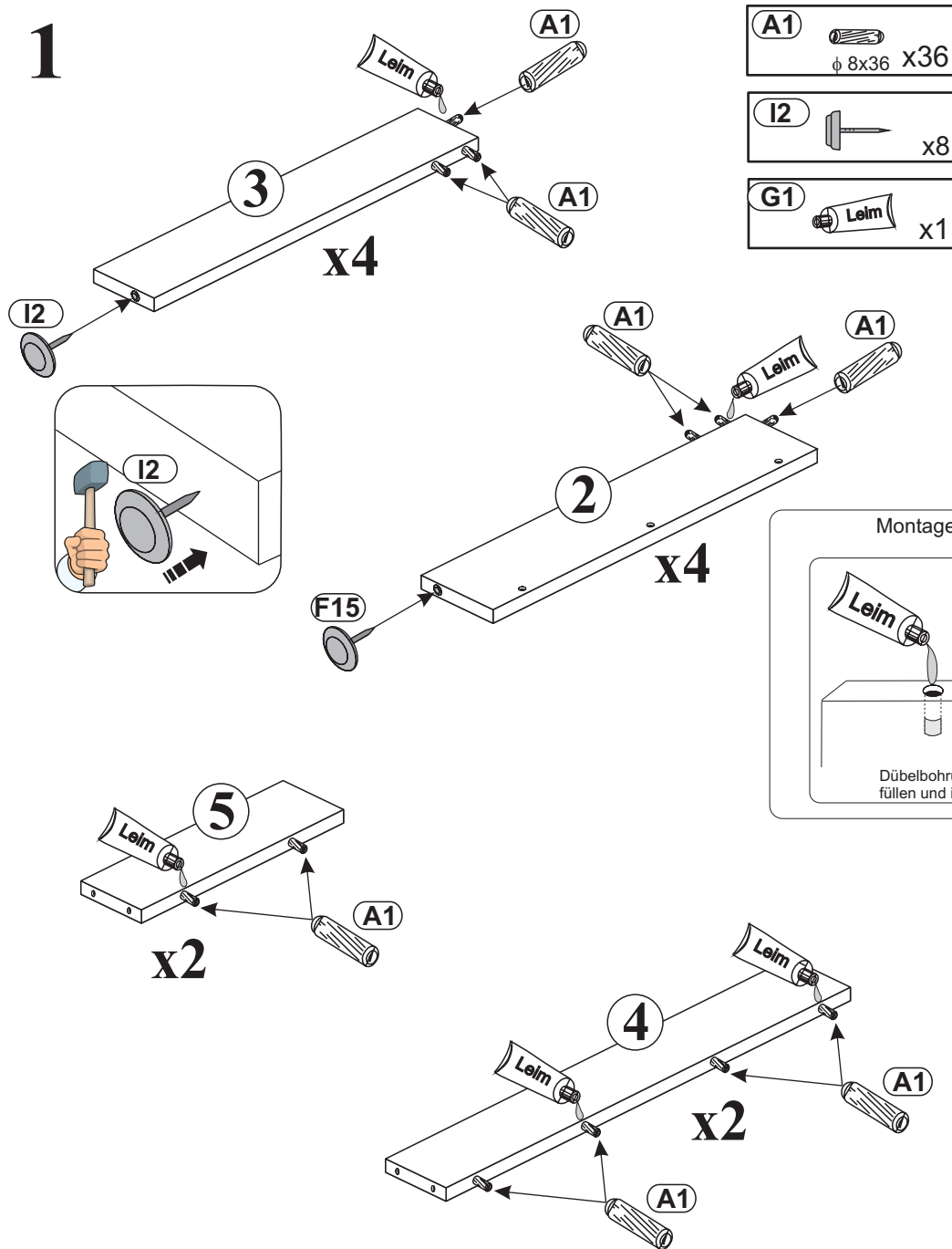

2

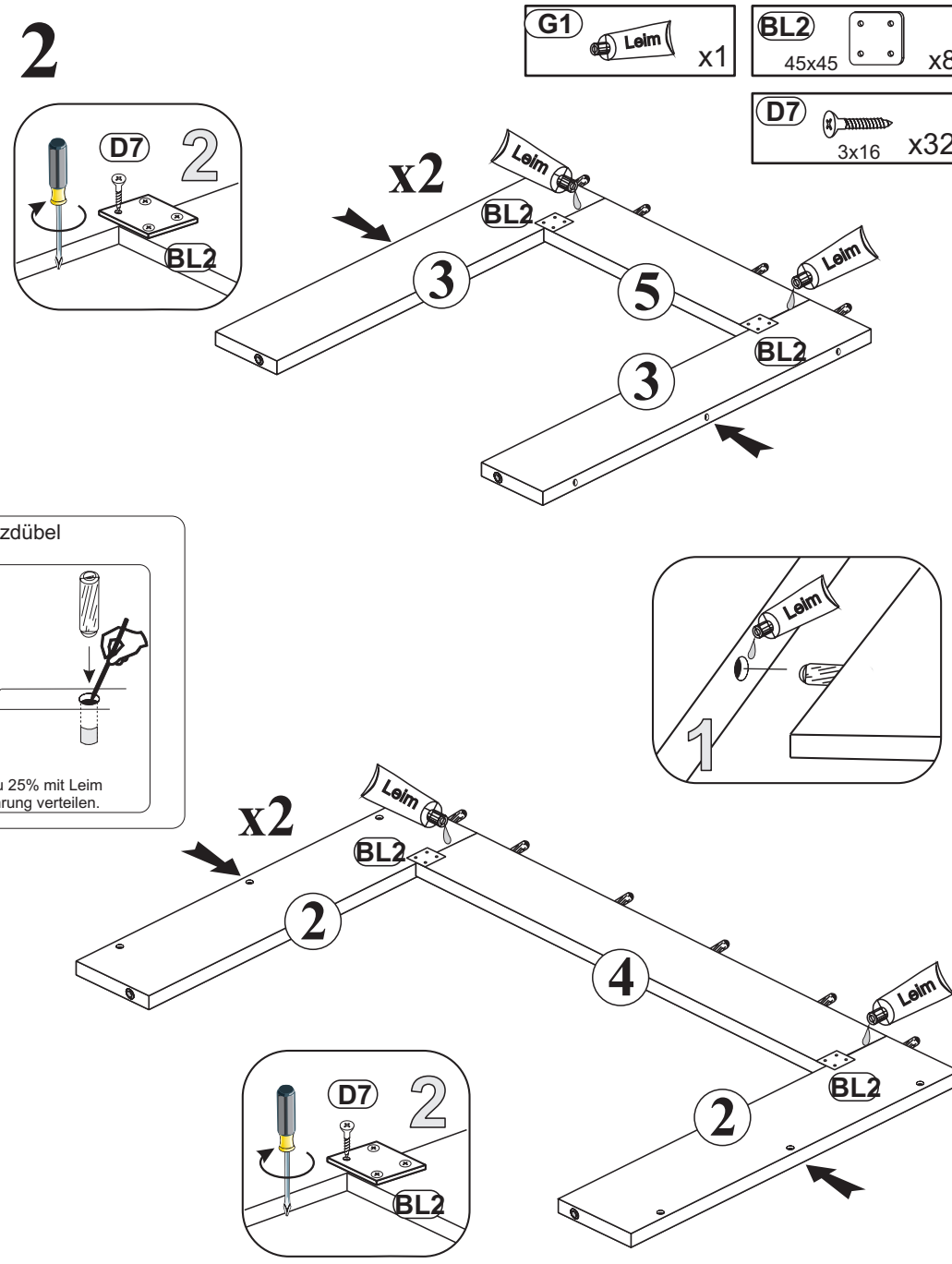

Montage Holzdübel

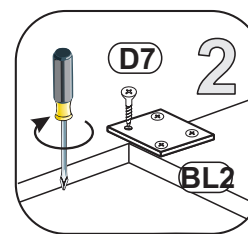
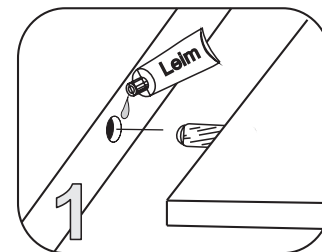
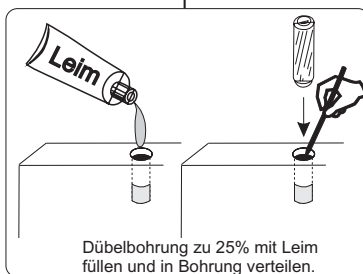

3

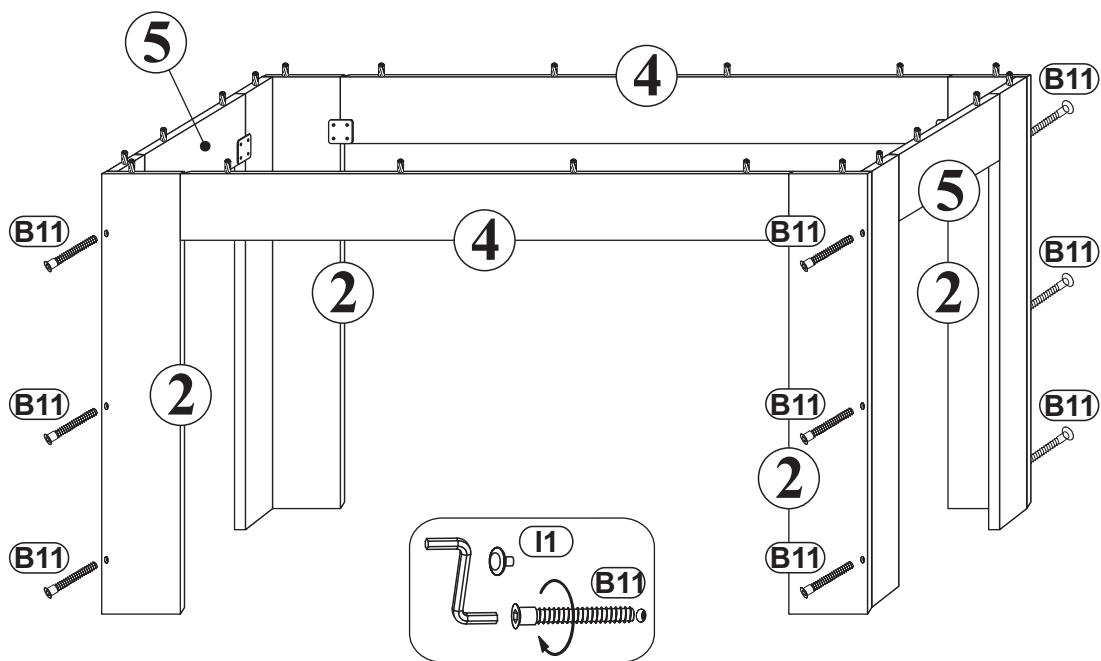
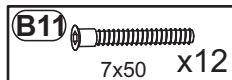

4

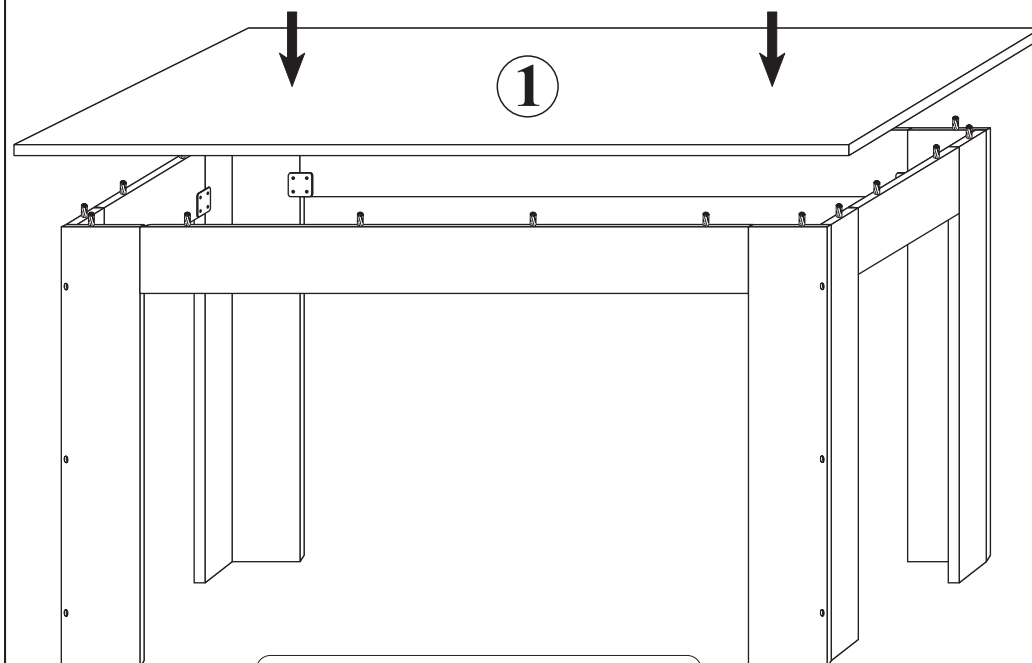
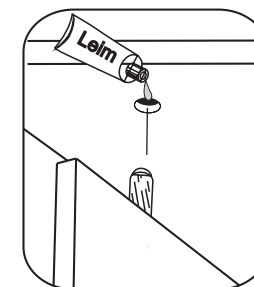
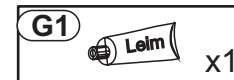

Montage Holzdübel

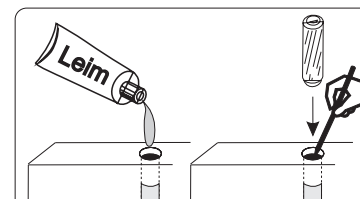

Dübelbohrung zu 25% mit Leim füllen und in Bohrung verteilen.